



SILL PLATE GUIDE

PWT TREATED LVL

TREATED LAMINATED VENEER LUMBER

PWT FOCUSED ON EWP

- **PWT Treated™ LVL** is Structural Composite Lumber (SCL) that is treated for protection against damage caused by decay, fungal rot, and wood-destroying insects including Formosan termites
- **PWT Treated LVL** may be used in interior above-ground applications (UC3B) including components that are difficult to maintain, repair, or replace and that are critical to the performance and safety of the entire system
- **PWT Treated LVL** and its chemical additive do not corrode or damage hardware
- Uniquely protected from the inside out; since there is no treatment gradient there is no need to field treat after cutting or drilling. Coat holes with a sealer or paint in applications where swelling due to exposure is a concern
- Limited 25-year transferable product warranty
- Available in: 1-1/2"x 3-1/2", 5-1/2", 7-1/4", 9-1/4", 11-1/4"

**PWT
TREATED™**
TREATED RIGHT™
BY PWT™

All handling, storage, and installation instructions must be followed and can be found at pwtewp.com.



PWT Treated™ LVL Sill Plates

Must be installed within the building envelope

Flashing is not required when PWT Treated LVL is installed within the building envelope.

Reference Design Values

DRY USE

	Plank Orientation
Compression Perpendicular to Grain, $F_c^{(1)}$ =	650 psi

- (1) Do not adjust for load duration.
- (2) See APA Product Report [PR-L329](#).
- (3) Dry use (dry service) for structural composite lumber products refers to an application where the in-service equilibrium moisture content of wood is less than 16%.

EQUIVALENT SPECIFIC GRAVITY FOR CONNECTION DESIGN

Connection Type	Face ⁽¹⁾	Edge ⁽²⁾
Nail - Withdrawal	0.50	0.47
Nail - Lateral	0.50	0.50
Bolt - Lateral	0.50	N/A

- (1) Face: member faces showing the face of one veneer, typically the wide face of the member.
- (2) Edge: member faces showing the narrow edge of all veneers, typically the narrow face of the member.

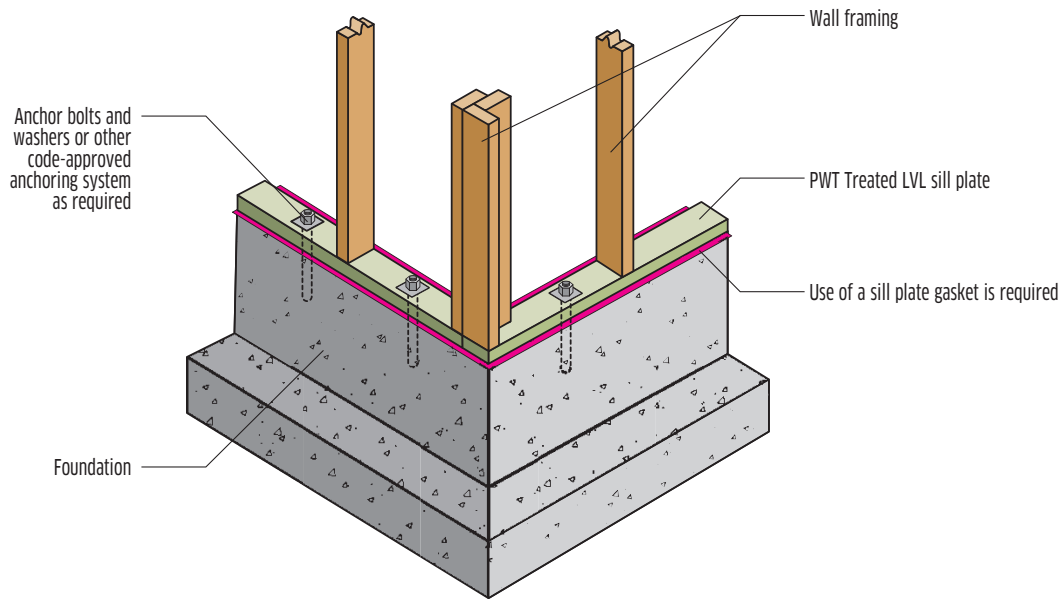

1850 Park Lane Burlington, WA 98233

TF 888.707.2285

pwtewp.com

For product catalog and complete warranty details or for more information on the full line of PWT products or the nearest distributor, visit pwtewp.com.

PWT Treated LVL is manufactured in the United States.



⚠ CAL. PROP 65 WARNING: Drilling, sawing, sanding or machining wood products can expose you to wood dust, a substance known to the State of California to cause cancer. Avoid inhaling wood dust or use a dust mask or other safeguards for personal protection. For more information go to www.P65Warnings.ca.gov/wood.

© 2026 Pacific Woodtech Corporation. All rights reserved. APA, APA Rated, and APA Product Report are registered trademarks of APA – The Engineered Wood Association. PWT™ is a registered trademark of Pacific Woodtech Corporation. Printed in USA. Specifications (details) subject to change without notice.

NOTE: PWT periodically updates and revises its product information. To verify that this version is current, contact the nearest sales office, visit pwtewp.com, or call 888.707.2285.